

This drawing is valid only if with corresponding edition stamp

# Side View

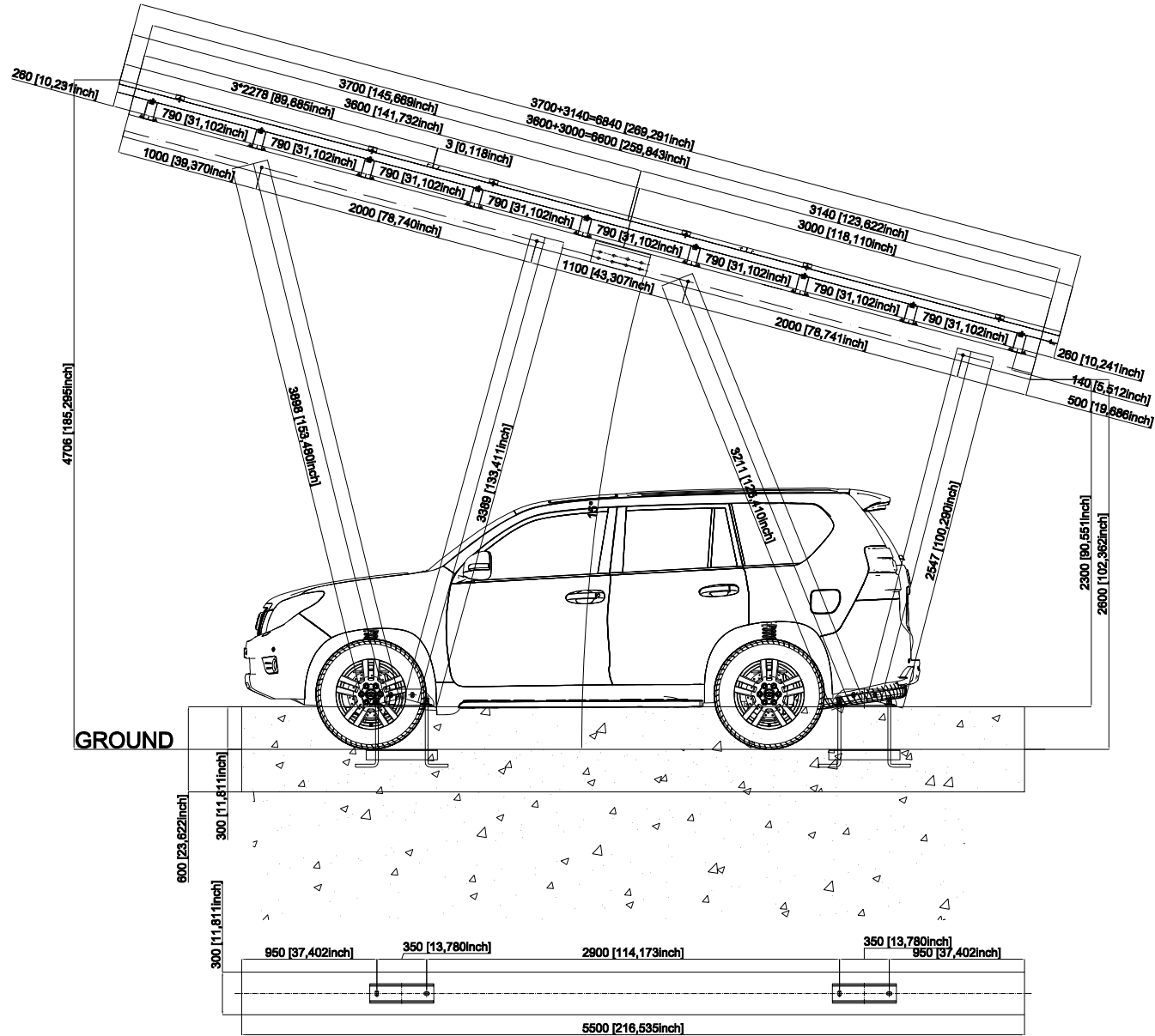

|           |              |                    |       |              |                          |           |        |        |        |           |        |                      |      |
|-----------|--------------|--------------------|-------|--------------|--------------------------|-----------|--------|--------|--------|-----------|--------|----------------------|------|
| Item Code | PJ-251022-06 |                    | Panel | 2278*1134*35 | Power                    | 600W      | Angle  | 15°    | Design | Chk'D     | Appv'D | Do Not Scale Drawing |      |
|           | Proj. Name   | CARPORT 2          |       | Wind Speed   | 55 m/s                   | Snow Load | 60 PSF | Layout |        |           |        |                      | View |
|           |              | Terrain Categories |       | Design Code  | ASCE 7-10<br>AISC 360-10 |           |        |        | Date   | 2026-2-12 | Ver.   | V08                  |      |

This drawing is valid only if with corresponding edition stamp

# Top View

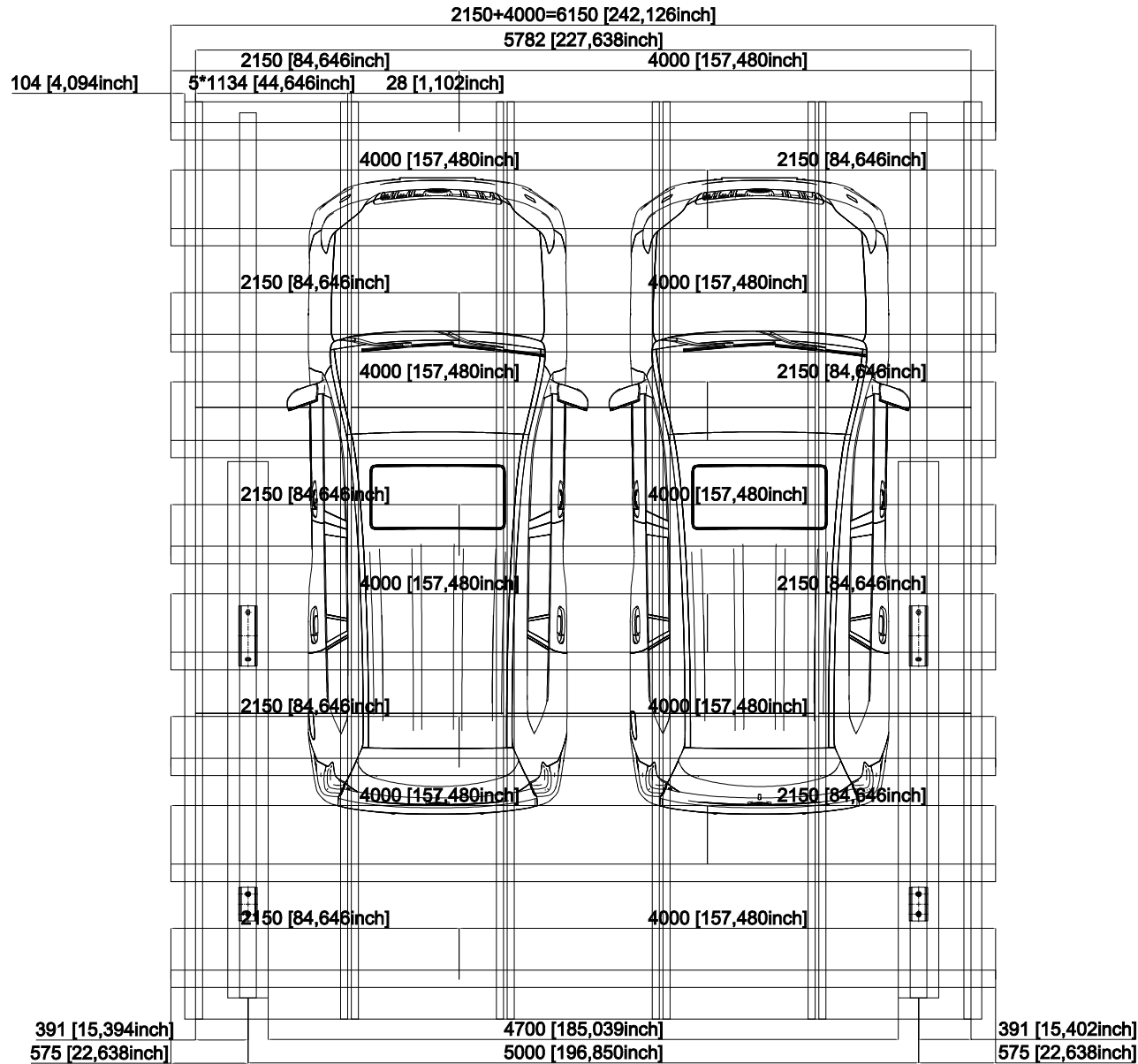

|            |              |
|------------|--------------|
| Item Code  | PJ-251022-06 |
| Proj. Name | CARPORT 2    |

|                    |              |             |                          |        |     |
|--------------------|--------------|-------------|--------------------------|--------|-----|
| Panel              | 2278*1134*35 | Power       | 600W                     | Angle  | 15° |
| Wind Speed         | 55 m/s       | Snow Load   | 60 PSF                   | Layout | 3*5 |
| Terrain Categories |              | Design Code | ASCE 7-10<br>AISC 360-10 |        |     |

|        |           |        |                      |  |  |
|--------|-----------|--------|----------------------|--|--|
| Design | Chk'D     | Appv'D | Do Not Scale Drawing |  |  |
|        |           |        | View Scale 1:1       |  |  |
| Date   | 2026-2-12 | Ver.   | V08                  |  |  |

1

2

3

4

5

6

This drawing is valid only if with corresponding edition stamp

A

A

# Front View of waterproof layer

B

B

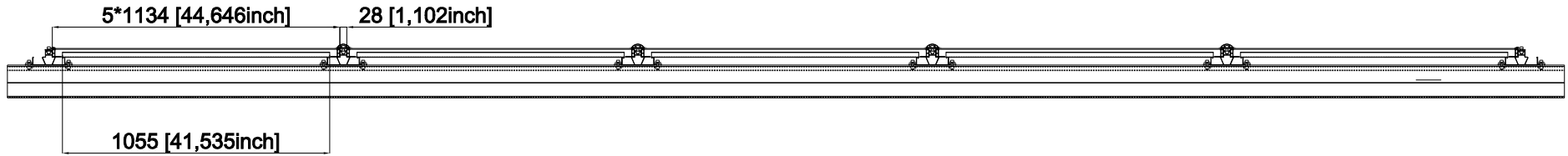

C

C

D

D



|           |              |           |                    |              |             |                          |        |     |        |       |           |                      |     |  |
|-----------|--------------|-----------|--------------------|--------------|-------------|--------------------------|--------|-----|--------|-------|-----------|----------------------|-----|--|
| Item Code | PJ-251022-06 |           | Panel              | 2278*1134*35 | Power       | 600W                     | Angle  | 15° | Design | Chk'D | Appv'D    | Do Not Scale Drawing |     |  |
|           | Proj. Name   | CARPORT 2 | Wind Speed         | 55 m/s       | Snow Load   | 60 PSF                   | Layout | 3*5 |        |       |           | View Scale 1:1       |     |  |
|           |              |           | Terrain Categories |              | Design Code | ASCE 7-10<br>AISC 360-10 |        |     |        | Date  | 2026-2-12 | Ver.                 | V08 |  |

This drawing is valid only if with corresponding edition stamp

D-shaped Waterproof Tape

If there are grooves, gluing is the waterproof treatment (Glue is provided by customer)

Solar Panel

Transverse Flume

M20\*160 Bolt Kit

Splice of Wide Rail 130

M20\*500 Embedded bolt Kit

Inter Clamp Kit

End Clamp Kit

BIPV Waterproof Rail

Transverse Flume

M20\*140 Bolt Kit

Wide Rail 130

M12\*140 Bolt Kit

4 ST6.3\*25 self-tapping screws

Splice for BIPV Waterproof Rail

BIPV Waterproof Rail

Transverse Flume

Apply glue and waterproof treatment between the supporting board and the main water tank (Glue customer supply)



|           |              |                         |         |              |        |             |                          |        |        |       |        |                      |           |      |
|-----------|--------------|-------------------------|---------|--------------|--------|-------------|--------------------------|--------|--------|-------|--------|----------------------|-----------|------|
| Item Code | PJ-251022-06 |                         | Panel   | 2278*1134*35 | Power  | 600W        | Angle                    | 15°    | Design | Chk'D | Appv'D | Do Not Scale Drawing |           |      |
|           | Proj. Name   | CARPORT-Main Connection |         | Wind Speed   | 55 m/s | Snow Load   | 60 PSF                   | Layout |        |       |        |                      |           | View |
|           |              |                         | Terrain | Categories   |        | Design Code | ASCE 7-10<br>AISC 360-10 |        |        |       |        | Date                 | 2026-2-12 | Ver. |

This drawing is valid only if with corresponding edition stamp

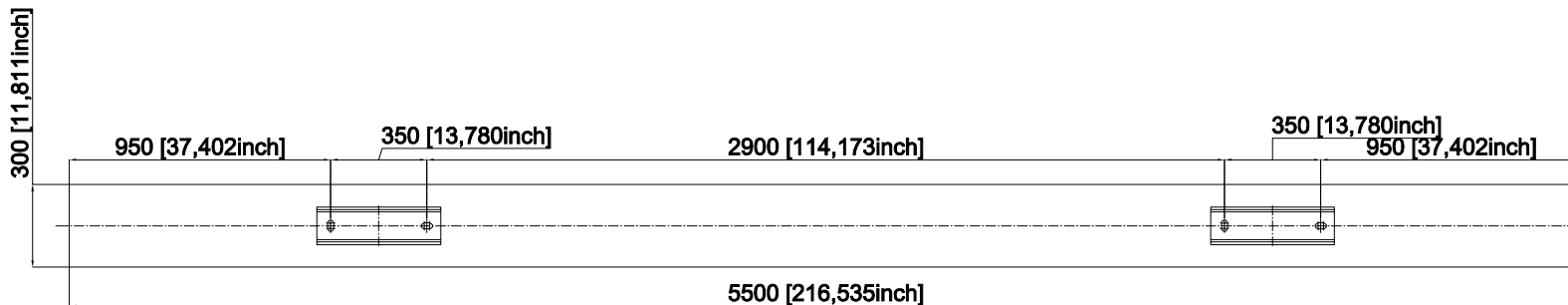

### Foundation of Carport 2/4

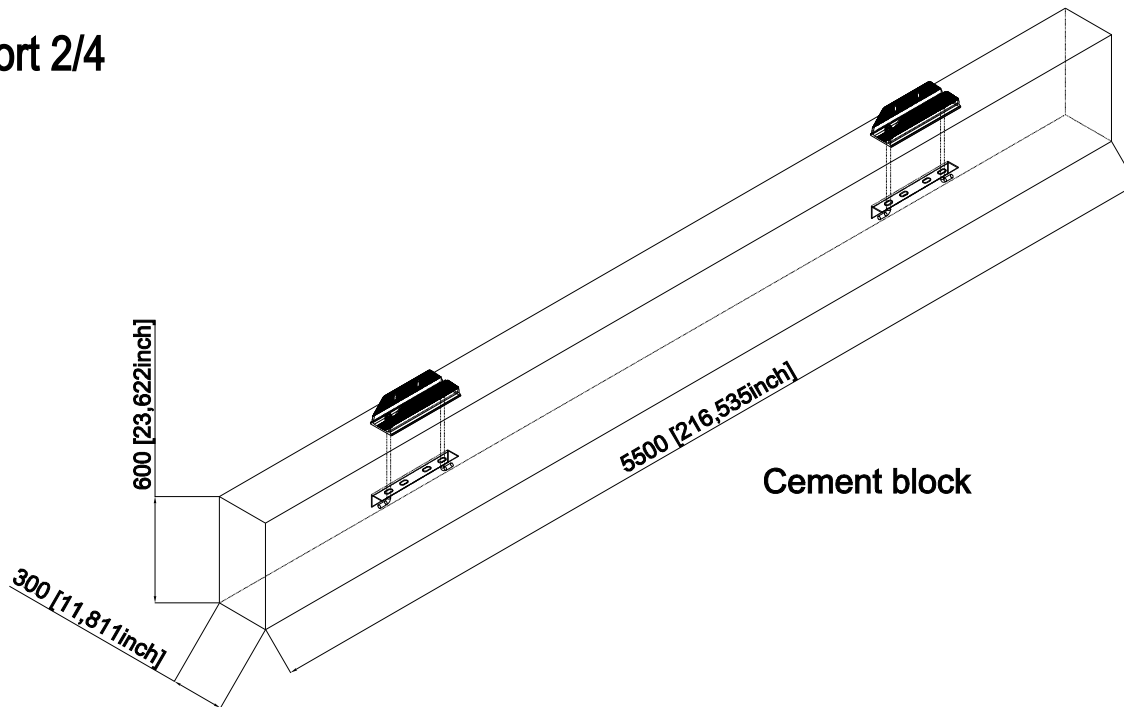

|           |              |           |                    |              |             |                          |        |           |        |       |        |                      |      |           |
|-----------|--------------|-----------|--------------------|--------------|-------------|--------------------------|--------|-----------|--------|-------|--------|----------------------|------|-----------|
| Item Code | PJ-251022-06 |           | Panel              | 2278*1134*35 | Power       | 600W                     | Angle  | 15°       | Design | Chk'D | Appv'D | Do Not Scale Drawing |      |           |
|           | Proj. Name   | CARPORT 2 | Wind Speed         | 55 m/s       | Snow Load   | 60 PSF                   | Layout |           |        |       |        |                      | View | Scale 1:1 |
|           |              |           | Terrain Categories |              | Design Code | ASCE 7-10<br>AISC 360-10 | Date   | 2026-2-12 | Ver.   | V08   |        |                      |      |           |